



Community
Meeting
#3

Why We're Here

Recap: Ideas Under Consideration

Timeline

2011-12

School Community
Essential Planning Process

2012-13

Facilities Task Force

Sept 2013

Failed Bond Issue Election

Jan-June 2014

Revisit & Re-examine

- Board of Education : Needs & Alternatives
- Community Input : Feedback & Priorities

Enrollment Projections

Possible Growth Projections

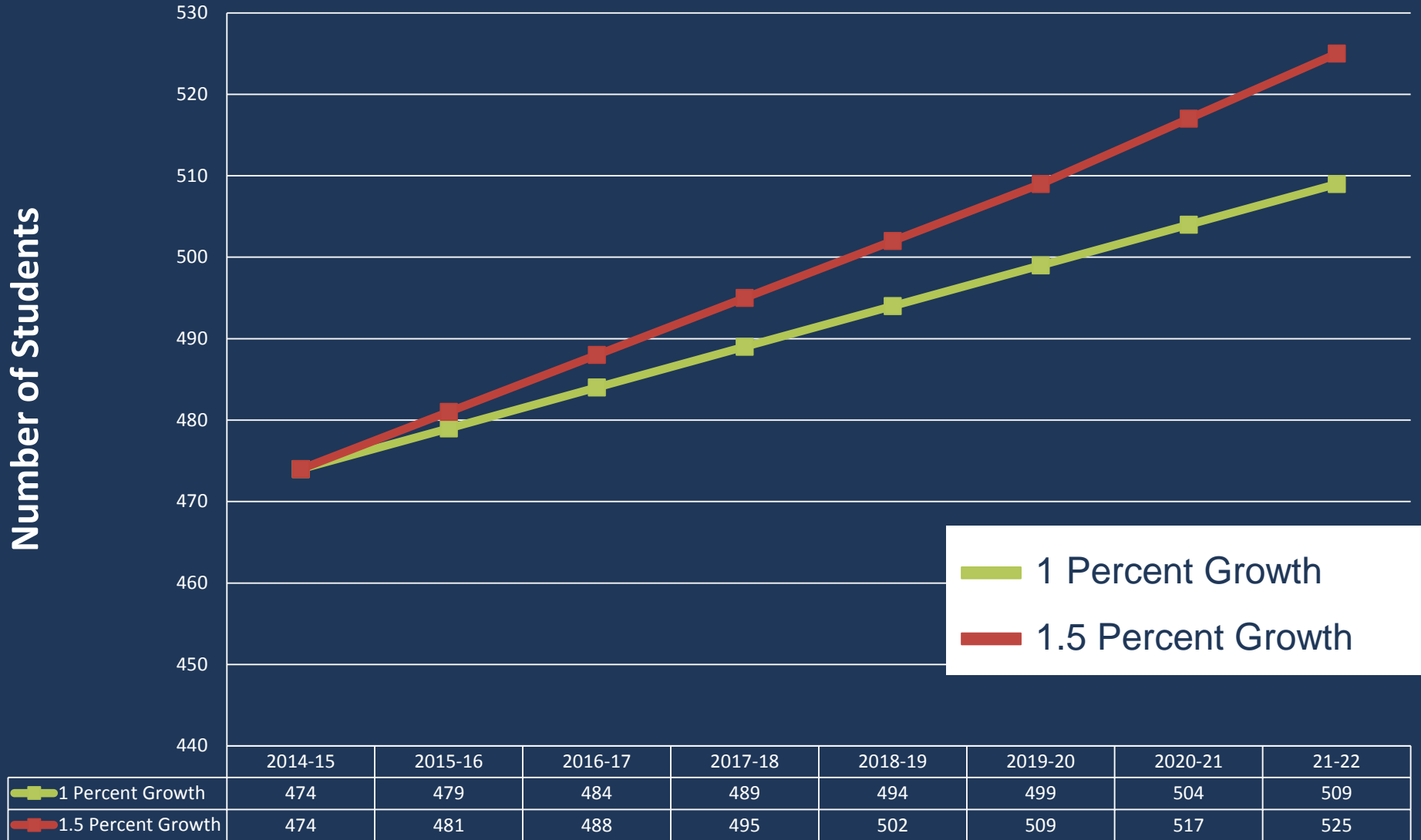

Review of Needs

1. Pre-School Expansion
2. Building Maintenance & Code Upgrades
3. Fine Arts Upgrades
4. Additional Gym Space
5. Outdoor Athletic & Activity Spaces
6. Technology - Infrastructure & Capacity
7. Security

Needs Identified



Academic

Additional Classrooms
Pre-School Expansion, Career Center



Arts

Music Rooms, Theatre,
Concerts, Speech



Athletics

Additional Gym,
Outdoor Track/Football Field



Commons/Community Use

Secure Entries, Assembly areas

Narrowing the Options

#1 Bennet Elementary - \$3.4 million



#2. Palmyra High School - \$7.5 million

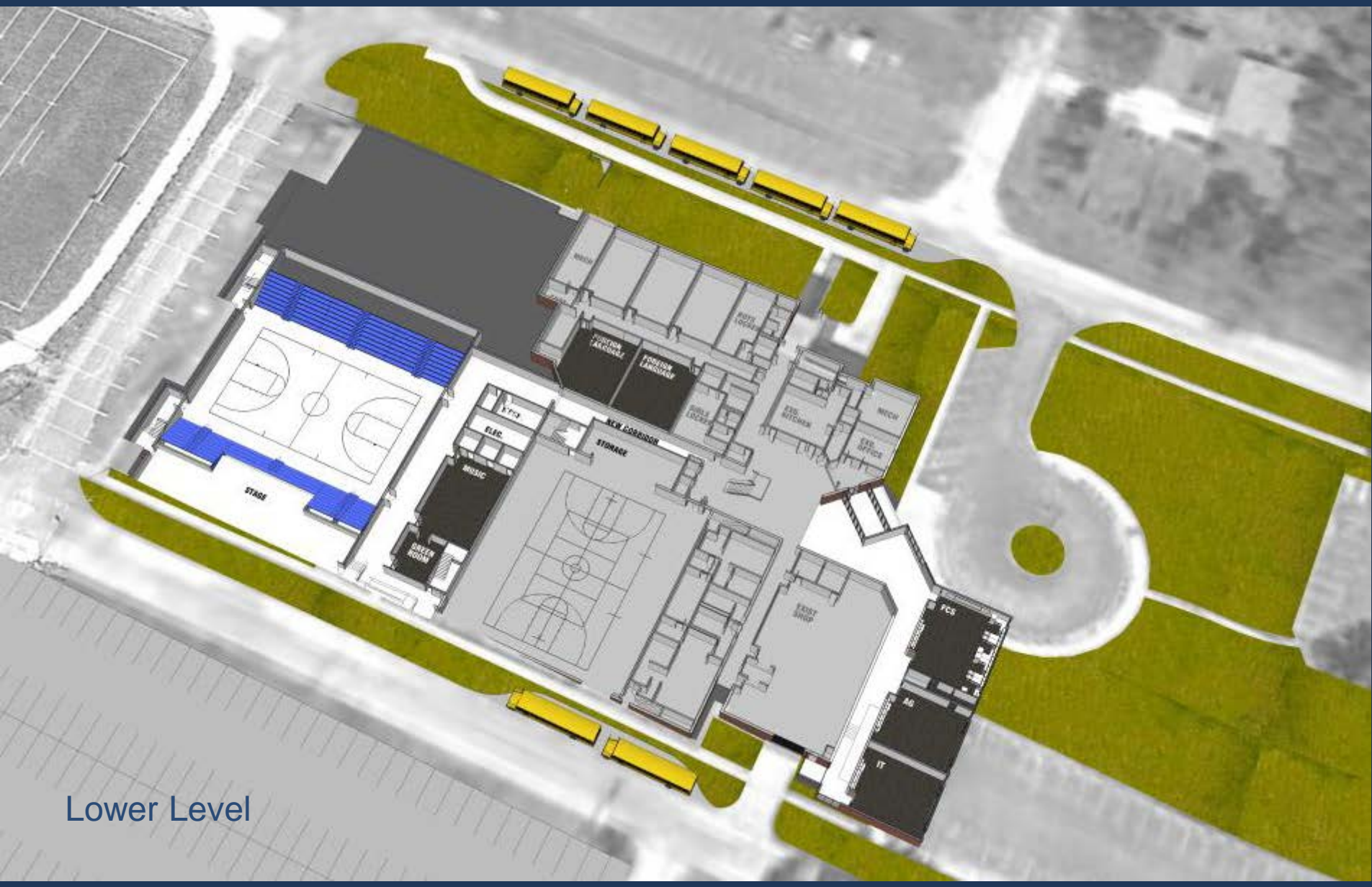

Lower Level

#2. Palmyra High School

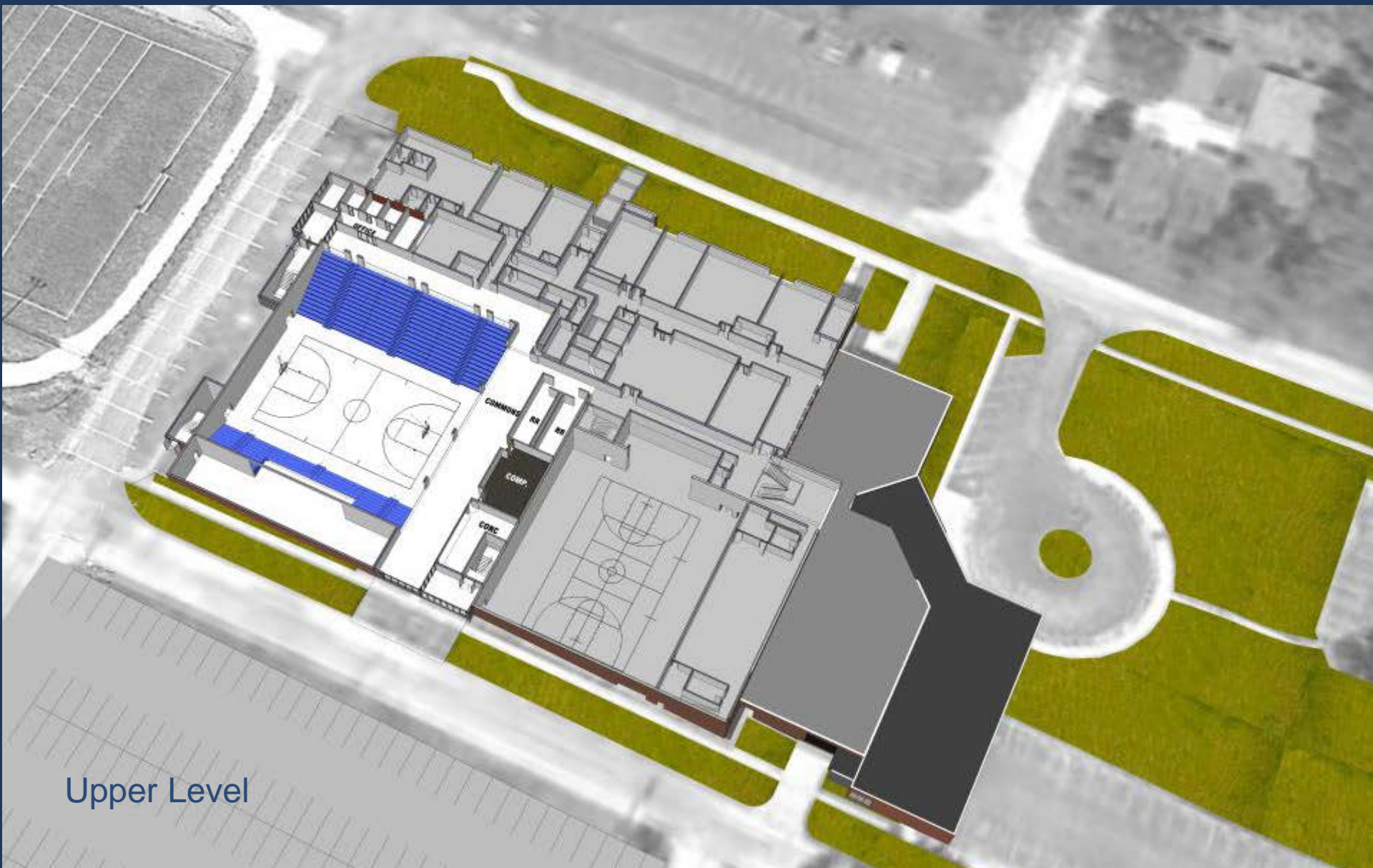

Upper Level

#3 Track/Football Field - \$1.8 million OR Track/Practice Field = \$600,000



**FOOTBALL
FIELD OPTION:**
Track, Football
Field, concessions,
restroom,
bleachers, lighting,
parking
= \$1.8 million

**PRACTICE
FIELD OPTION:**
Track, Practice
Field, minimal
amenities, no
lighting, minimal
parking
Future phases
= \$600,000

Palmyra High School

“Why do we need more gym space?”

TYPICAL ATHLETIC DAY

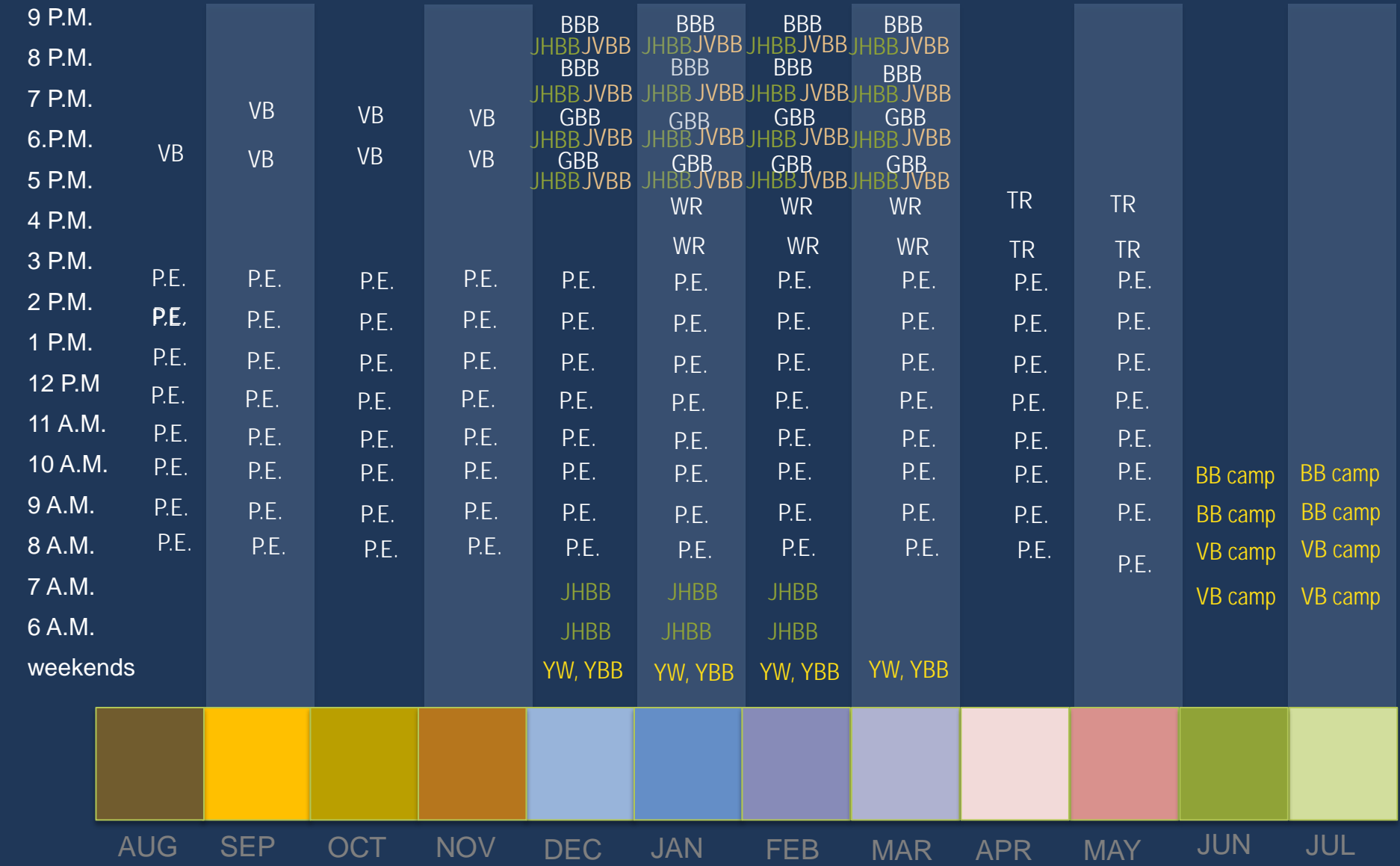

Athletic Facility Benchmarks

“How do our athletic facilities compare to other Districts in our conference?”

ATHLETIC FACILITIES IN CONFERENCE						
SCHOOL DISTRICT	LOCKER ROOMS	COMPETITIVE GYM	PRACTICE GYM	TRACK	FOOTBALL PRACTICE FIELD	WRESTLING PROGRAM
Connestoga	4	2	1	Yes	Yes	Yes
Johnson County	4	2	2	Yes	Yes	Yes
Malcolm	4	2		Yes	Yes	Yes
Louisville	6	2		Yes	Yes	Yes
Elmwood Murdock	4	3		No	Yes	No
Freeman	4	2		Yes	Yes	Yes
Weeping Water	4	2		No	Yes	Yes
Yutan	4	2	1	Yes	Yes	Yes
Auburn	4	1	2	Yes	Yes (3)	Yes
Mead	2	1	1	No	Yes	No
East Butler	2	1	2	No	Yes	Yes

Ballot Issue Option: Single Ballot issue

\$12.7 million

Bennet & Palmyra School Improvements
+ \$1.8M Track/Football Field

OR

\$11.5 million

Bennet & Palmyra School Improvements
+ \$600,000 Track/Practice Field

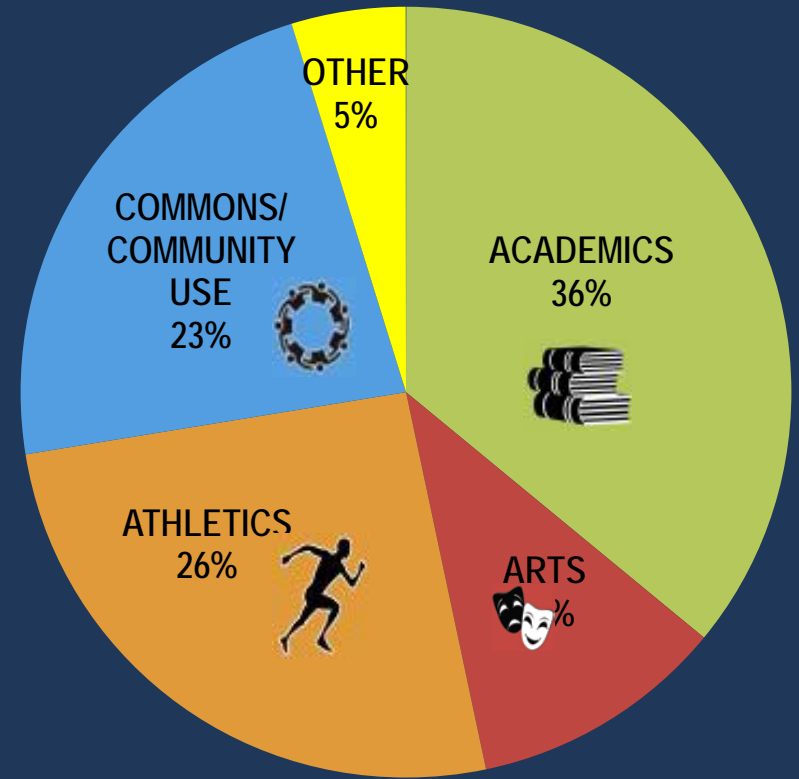
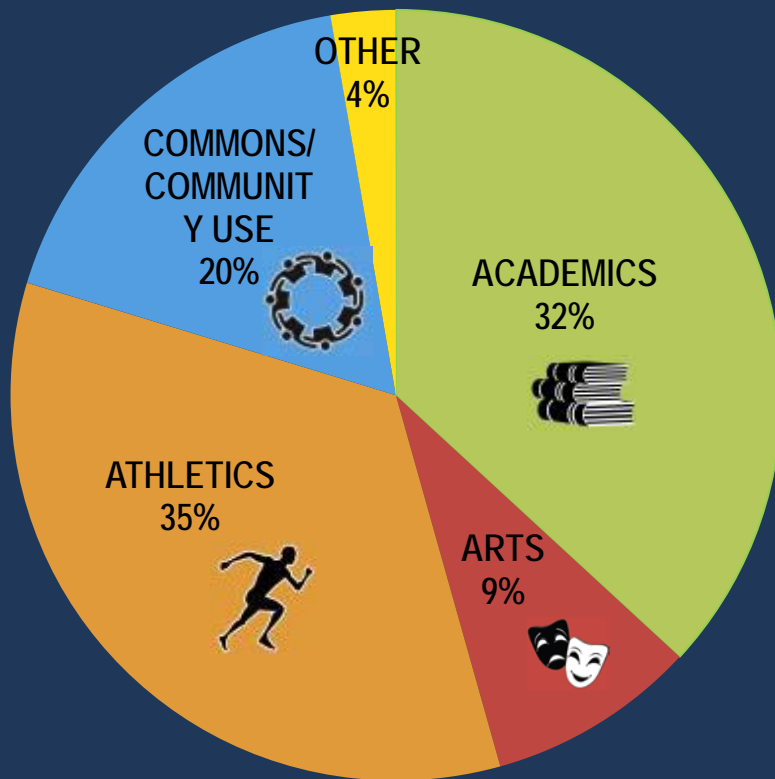

Ballot Issue Option: Two ballot issues

\$10.9 million

AND

\$1.8 million or \$600,000

Bennet & Palmyra School Improvements
(separate vote)

Track + either Football or Practice Field
(separate vote)

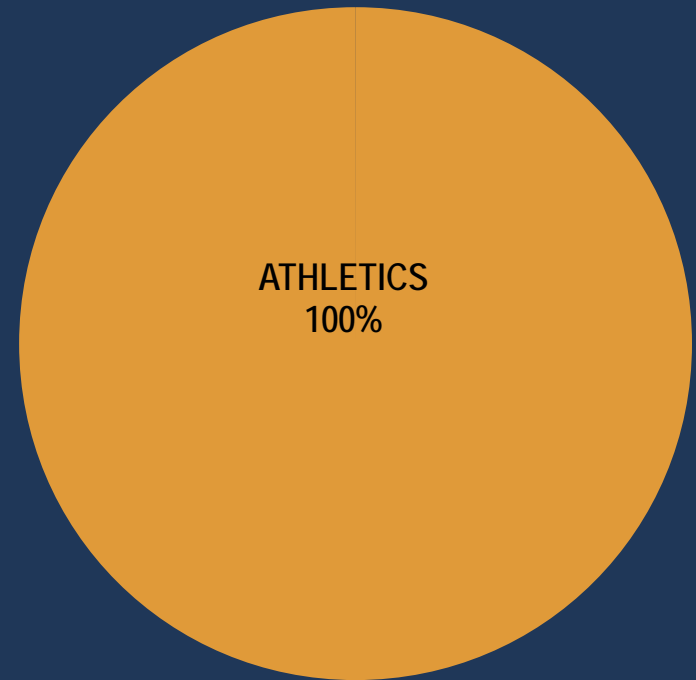
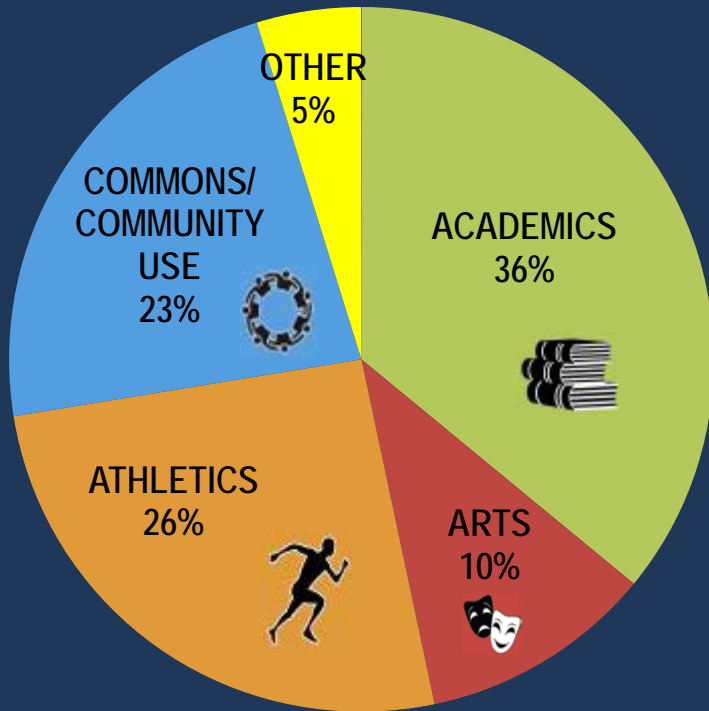

Bond Issue Impact

Finances & Refinements

Other Districts

“How does District OR-1’s levy compare to what other Districts pay?”

2013/14 LEVIES (lowest to highest)	Bond Fund	Building	Qualified		
School District	General	Levy	Fund levy	Fund Levy	Total
TRI COUNTY PUBLIC SCHOOLS	0.6478	0.01530	0.03110	0.00000	0.6942
JOHNSON-BROCK PUBLIC SCHOOLS	0.7738	0.06420	0.06380	0.00000	0.9018
SYRACUSE-DUNBAR-AVOCA SCHOOLS	0.9507	0.07500	0.01540	0.00000	1.0411
DORCHESTER PUBLIC SCHOOLS	0.9514	0.10860	0.00000	0.00000	1.0600
ASHLAND-GREENWOOD PUBLIC SCHS	0.9690	0.09140	0.00000	0.01000	1.0704
MILFORD PUBLIC SCHOOLS	0.9740	0.05130	0.00000	0.00000	1.0253
WILBER-CLATONIA PUBLIC SCHOOLS	0.9500	0.10300	0.01990	0.03920	1.1121
MALCOLM PUBLIC SCHOOLS	1.0026	0.06570	0.04040	0.01230	1.1210
PALMYRA DISTRICT O R 1	0.9995	0.07350	0.04960	0.00000	1.1226
STERLING PUBLIC SCHOOLS	0.9760	0.08270	0.07360	0.00000	1.1323
ELMWOOD-MURDOCK PUBLIC SCHOOLS	0.9509	0.17800	0.00000	0.01980	1.1487
JOHNSON CO CENTRAL PUBLIC SCHS	1.0133	0.11500	0.03660	0.00000	1.1649
FREEMAN PUBLIC SCHOOLS	0.9580	0.16720	0.04740	0.00000	1.1726
YUTAN PUBLIC SCHOOLS	0.9033	0.16580	0.08330	0.02830	1.1807
NORRIS SCHOOL DIST 160	1.0322	0.09930	0.01660	0.03640	1.1845
LOUISVILLE PUBLIC SCHOOLS	0.9958	0.12100	0.05410	0.02340	1.1943
RAYMOND CENTRAL PUBLIC SCHOOLS	1.0300	0.16500	0.01990	0.00000	1.2149
WAVERLY SCHOOL DISTRICT 145	1.0404	0.12310	0.00910	0.04400	1.2166
LINCOLN PUBLIC SCHOOLS	1.0500	0.16430	0.00000	0.02980	1.2441
WEeping WATER PUBLIC SCHOOLS	1.0346	0.27980	0.04830	0.03060	1.3933

District Levy

“What would a bond issue do to our levy?”

LEVY IMPACT							
Year	General	Bond Fund Levy	Building Fund Levy	Qualified Fund Levy	Total		
01/02	1.0000	0.1303		0.0000	1.1303		
02/03	1.0194	0.2228	0.0010	0.0000	1.2432		
03/04	1.0495	0.1918	0.0005	0.0000	1.2418		
04/05	1.0646	0.1529		0.0000	1.2175		
05/06	0.9605	0.0944	0.0556	0.0000	1.1106		
06/07	0.9682	0.0877	0.0542	0.0000	1.1101		
07/08	0.9772	0.1085	0.0524	0.0000	1.1380		
08/09	1.0029	0.1035	0.0470	0.0000	1.1534		
09/10	1.0000	0.0998	0.0500	0.0000	1.1498		
10/11	0.9984	0.1022	0.0495	0.0000	1.1501		
11/12	1.0025	0.0940	0.0471	0.0000	1.1436		
12/13	0.9996	0.0811	0.0502	0.0000	1.1309		
13/14	0.9995	0.0735	0.0496	0.0000	1.1226		
no bond issue →	14/15 *	0.9618	0.0634	0.0497	0.0000	1.0749	5 cent reduction
only BES/PHS (\$10.9M) →	14/15 *	0.9618	0.1861	0.0483	0.0000	1.1962	7 cent increase
BES/PHS + Track/Practice field (\$11.5M) →	14/15 *	0.9618	0.1960	0.0483	0.0000	1.2061	8 cent increase
BES/PHS + Track/Football (\$12.7M) →	14/15 *	0.9618	0.2159	0.0483	0.0000	1.2260	10 cent increase
* estimated projections							

Taxpayer Impact

“How much more would this cost me ?

On a home with an assessed value of \$100,000, here's how to calculate your tax impact:

No Bond Issue: The levy will be reduced by 5 cents. On a \$100,000 home, you would pay about \$50 less per year.

Bennet & Palmyra School Improvements Only (\$10.9M) The levy will be increased by 7 cents. On a \$100,000 home, you would pay about \$70 more per year.

Bennet & Palmyra School Improvements + Track/Practice Field (\$11.5M) The levy will be increased 8 cents. On a \$100,000 home, you would pay about \$80 more per year.

Bennet & Palmyra School Improvements + Track/Football Field w/ lights, etc. (\$12.7M) The levy will be increased 10 cents increase to your taxes. On a \$100,000 home, you would pay about \$100 more per year.

What We're Hearing

On MindMixer and at Meetings



mindmixer

ACTIVATE COMMUNITY CONTRIBUTORS

Bennet - Palmyra Schools

Share your ideas. Be heard. Build a better community.



SITE LAUNCH

Bennet - Palmyra Schools is now active.

July 1, 2014

Spread the word:



What is MindMixer? >

What is MindMixer?

How It Works >

FAQ >

Top Contributors >

Rewards Store >

Need Help? >

bennetpalmyraschools.mindmixer.com



mindmixer

ACTIVATE COMMUNITY CONTRIBUTORS

TRAFFIC

Unique Visitors	573
Active Participants	89
Page Views	6,108

PARTICIPANTS

Male	32%
Female	68%
Average Age	37

RESIDENTS OF

68317	Bennet	40
68418	Palmyra	31
68508	Lincoln	4
68516	Lincoln	2
68526	Lincoln	2
68372	Lincoln	1
68503	Lincoln	1
68506	Lincoln	1
68507	Lincoln	1
68620	Albion	1
68344	Douglas	1



mindmixer

ACTIVATE COMMUNITY CONTRIBUTORS



Narrowing the Options

Are these the right projects?

"I agree these are the right projects. We need to make a "total" commitment to our children - whether it be in the classroom or extracurricular activities. The board plus the architects are to be commended for not throwing in the towel but thinking outside the box to identify a wide variety of options."

"The three proposed projects address the needs that were identified through the extensive process completed by the board and the facility task force and audit. The time is right to take advantage of the low interest rates and in my opinion this is a reasonable and great investment in the future of our district and will provide the facilities the students need."

"The 3 proposed projects address the needs of OR1 in the most responsible way, in my opinion. A brand new K-12 school would obviously have its advantages, but it would cost quite a bit and the 2 existing schools would just go to waste....."



mindmixer

ACTIVATE COMMUNITY CONTRIBUTORS

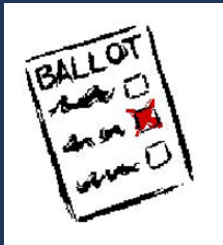

Do you think the projects should be offered as a single ballot issue or as two separate ballot issues?

Single Ballot Issue	20 votes
Two Ballot Issues	4 votes
Neither	1 vote

QUESTIONS:

If there are two ballots does that mean 2 separate bonds?

If it is two would they be combined later?

Is there a financial advantage to having a single or 2 separate?

Community Meeting Comments

“Why is the K-12 school off the table?”

“What is the negative impact on our school if a second bond issue would fail?”

“What happens to the old football field with any of these plans?”

“About LPS growth... as people who live near Lincoln have valuation increases, that will help the base for our bond. We will be able to use that valuation before that land eventually moves into the Lincoln school district. Then a smaller amount of landowners will be supporting the schools. This is important because, as enrollment drops, the state aid also lessens. The district has no control over valuation, but it can bring in more students or at least keep from losing students to bring in more aid.”

What Do YOU Think?

Questions & Comments

Next Steps

Community Meetings

- August 6, (7PM) Meeting #3
- August 18, Board decision
- September ??, Meeting #4
- October ??, Meeting #5

Board Face-to-Face

- Civic group presentations
- Personal meetings on request



**Let's talk about our
School Buildings!**

Our school district has more information to share about options for improving our schools in Bennet & Palmyra

Here are some opportunities to learn about ideas under consideration and share your thoughts!

Next Public Meeting:

**7 p.m. August 6
Bennet Elementary School**

Please join the online community discussion at:

<http://bennetpalmyraschools.mindmixer.com>