

District OR-1

SPECIAL BOND "MAIL IN" ELECTION

Tuesday, August 9, 2022

Committed to the Future Needs of our Students and the Community



PROJECT DESCRIPTION

Bennet Elementary School

- Five new classrooms and one renovated classroom
- Expand kitchen and multi-purpose activity area
- Increase office area, nurse's office, and add a conference room
- Remodel / enhance the current gymnasium
- Add a multi-purpose activity space to the southeast corner of the gym



Palmyra Junior/Senior High School

- Three new classroom sections of 6th grade
- Four new content area classrooms – math, science, history, and English
- One new classroom for SPED and a new "Student Success Center" room
- Expand office and commons area – including an elevator and rest rooms
- A new flexible use area which may be used as a classroom, conference room, or community room
- Enhanced Career Technical Education (CTE) Area for metals, woods, and agriculture classes
- Garden level "shell space" for future growth and expansion
- Repurpose current shop and weight deck area

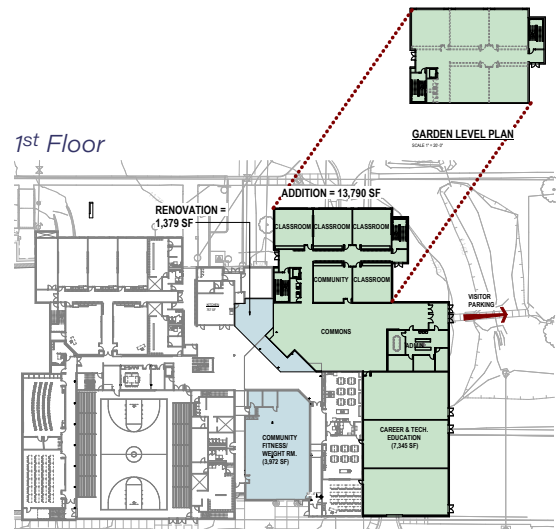
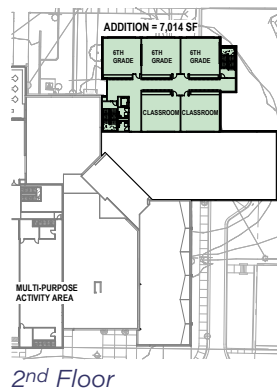

WHY NOW?

- Student enrollment continues to grow rapidly
- Existing facilities are over capacity
- Expand student learning opportunities to meet "in demand" college and Career Technical Education (CTE) job readiness skills that positively impact our communities and local businesses
- Support increased diversity of student needs: special education, poverty, behavioral, mental health, academic, technology, etc.
- Overall costs are steadily increasing – materials, labor, interest rates

TOTAL COST

Bond Amount Not to Exceed \$22 Million

Bennet Elementary School	\$7,335,250
Palmyra High School	\$14,552,099
Total Cost	\$21,887,349

If the voters approve the bond, final project design will proceed in Fall 2022/Winter 2023. Construction would begin in Spring 2023, and the project would be complete for the beginning of school year 2024-25.

IMPORTANT DATES

Thursday, July 14: Community Information Meeting at Palmyra Jr./Sr. High School at 6:30 p.m.

Monday, July 18: Ballots will be mailed to each registered voter residing within the District

Tuesday, July 19: Community Information Meeting at Bennet Elementary School at 6:30 p.m.

Friday, July 22: Last day for mail-in voter registration

Friday, July 29: Last day for in-person voter registration in the Election Commissioners office in Otoe or Lancaster Counties

Tuesday, August 9: Election Day. All ballots must be in the possession of the Election Commissioner of Lancaster County no later than 5:00 p.m.

TAXPAYER IMPACT

Bond Amount	Term	Levy Increase (based on 2020-21 taxable valuation)	Annual taxes for Residential (Non-Ag) per \$100,000 market value	Annual taxes for Agriculture per \$100,000 (based on 50% valuation per LB 2)
\$22,000,000	25 Years at 4.5%	22.4 cents	\$224.00	\$155.56

DID YOU KNOW?

- LB 2 took effect January 1, 2022. It states that when repaying school bonds, agriculture and horticulture land is valued at 50% of its actual value. Prior to LB 2, agriculture and horticulture land was valued at 72% of its actual value.
- Since November 2020, the district has conducted 34 meetings focused on facilities planning and 6 of those were community meetings.
- Student enrollment is exceeding projected growth. The District estimates that PreK-12 enrollment for school year 2022-23 will be 705 students.
- Enhancing Career Technical Education (CTE) benefits local businesses and the local economy by preparing students for technical careers in agriculture and trades.



Visit our website!

Together, we prepare our students to successfully meet the challenges of the future.

